

TEXAS BOARD OF WATER ENGINEERS

H. A. Beckwith, Chairman

A. P. Rollins, Member

James S. Guleke, Member

BULLETIN 5303

RECORDS OF WATER-LEVEL MEASUREMENTS IN LUBBOCK COUNTY, TEXAS

1936 - 1953

Compiled by

C. R. Follett, Engineer

Texas Board of Water Engineers

Prepared in cooperation with the Geological Survey,
United States Department of the Interior

October 1953

RECORDS OF WATER-LEVEL MEASUREMENTS IN LUBBOCK COUNTY, TEXAS

1936 - 1953

Compiled by

C. R. Follett, Engineer

Texas Board of Water Engineers

October 1953

This bulletin contains measurements of depths-to-water below land-surface datum in 150 wells in Lubbock County. The earliest reliable water-level measurements of which records are available were obtained in 1936. These and other subsequent measurements have been published from time to time in some of the publications in the following list. A large number of measurements that have never been published are included in this bulletin.

The purpose of this publication is to assemble all such measurements so that they can be studied collectively.

The data were obtained, compiled and published cooperatively by the United States Geological Survey and the Texas Board of Water Engineers.

LIST OF PUBLICATIONS

- ALEXANDER, W. H. Jr., and BROADHURST, W. L., Progress report on ground water in the High Plains in Texas, 1942. *
- ALEXANDER, W. H. Jr., and OTHERS, Progress report on ground water in the High Plains in Texas, 1943. *
- ALEXANDER, W. H. Jr., and LANG, J. W., Ground water in the High Plains of Texas, Progress report no. 5, 1945.
- BAKER, C. L., Geology and underground waters of the Northern Llano Estacado: Univ. of Texas Bull. 57, 1915. *
- BARNES, J. R., ELLIS, W. C., LEGGAT, E. R., SCALAPINO, R. A., and GEORGE W. O., Geology and ground water in the irrigated region of the Southern High Plains in Texas, Progress report no. 7, 1949.
- BROADHURST, W. L., and ALEXANDER, W. H. Jr., Progress report on ground water in the High Plains in Texas, 1944.
- BROADHURST, W. L., Ground water in High Plains in Texas, Progress report no. 6, 1947.
- GOULD, C. N., The geology and water resources of the eastern portion of the Panhandle of Texas, U. S. Geol. Survey Water-Supply Paper 154, 1906. *
- HUGHES, WILLIAM F., Cost of pumping water for irrigation Texas High Plains, 1951.
- HUGHETT, M. G., and BRIGANCE, B. G., Records of wells in Lubbock County, 1937. *
- JOHNSON, W. D., The High Plains and their utilization, U. S. Geol. Survey 21st Ann. Rept., pt. 4, Hydrology, pp. 609-741, 1901; 22d Ann. Rept., pt. 4, Hydrography, pp. 637-669, 1902. *
- LANG, J. W., Records of wells in Lubbock County, 1945.
- LANG, J. W., and TWICHELL, TRIGG, Water resources of the Lubbock district, Texas, 1953.
- LEGGAT, E. R., Development of wells for irrigation and fluctuation of water levels in the High Plains of Texas to January 1951, Bulletin 5104, 1951.
- MEINZER, O. E., and WENZEL, L. K., Water levels and artesian pressure in wells in the United States in 1937, U. S. Geol. Survey Water-Supply Paper 840, 1938.
- _____, Water levels and artesian pressure in wells in the United States in 1938, U. S. Geol. Survey Water-Supply Paper 845, 1939.
- _____, Water levels and artesian pressure in wells in the United States in 1939, U. S. Geol. Survey Water-Supply Paper 886, 1940.
- _____, Water levels and artesian pressure in observation wells in the United States in 1940, Part 4, U. S. Geol. Survey Water-Supply Paper 909, 1941.
- _____, Water levels and artesian pressure in observation wells in the United States in 1941, Part 4, U. S. Geol. Survey Water-Supply Paper 939, 1943.

LIST OF PUBLICATIONS

- MEINZER, O. E., and WENZEL, L. K., Water levels and artesian pressure in observation wells in the United States in 1942, Part 4, U. S. Geol. Survey Water-Supply Paper 947, 1944.
- _____, Water levels and artesian pressure in observation wells in the United States in 1943, Part. 4, U. S. Geol. Survey Water-Supply Paper 989, 1946.
- SAYRE, A. N., and OTHERS, Water levels and artesian pressure in observation wells in the United States in 1944, Part 4, U. S. Geol. Survey Water-Supply Paper 1019, 1947.
- _____, Water levels and artesian pressure in observation wells in the United States in 1945, Part 4, U. S. Geol. Survey Water-Supply Paper 1026, 1948.
- _____, Water levels and artesian pressure in observation wells in the United States in 1946, Part 4, U. S. Geol. Survey Water-Supply Paper 1074, 1949.
- _____, Water levels and artesian pressure in observation wells in the United States in 1947, Part 4, U. S. Geol. Survey Water-Supply Paper 1099, 1950.
- _____, Water levels and artesian pressure in observation wells in the United States in 1948, Part 4, U. S. Geol. Survey Water-Supply Paper 1129, 1951.
- _____, Water levels and artesian pressure in observation wells in the United States in 1949, Part 4, U. S. Geol. Survey Water-Supply Paper 1159, 1951.
- _____, Water levels and artesian pressure in observation wells in the United States in 1950, Part 4, U. S. Geol. Survey Water-Supply Paper 1168, 1952.
- WHITE, W. N., Ground water in the Texas High Plains, Texas State Bd. of Water Engr., Press release, Apr. 12, 1939. *
- WHITE, W. N., and OTHERS, Ground water in the High Plains in Texas, Texas State Bd. of Water Engr., 1938. *
- _____, Ground water in the High Plains in Texas, 1940, U. S. Geol. Survey Water-Supply Paper 889-F, 1946.
- _____, Ground water in the High Plains of Texas, Texas State Bd. of Water Engr., 1940. *

* Out of print. Copies available for references in most public libraries and at the Austin office of the U. S. Geological Survey.

LUBBOCK COUNTY, TEXAS OBSERVATION WELLS February 1953

Bulletin 5303
Texas Board of Water Engineers
in cooperation with
U. S. Geological Survey

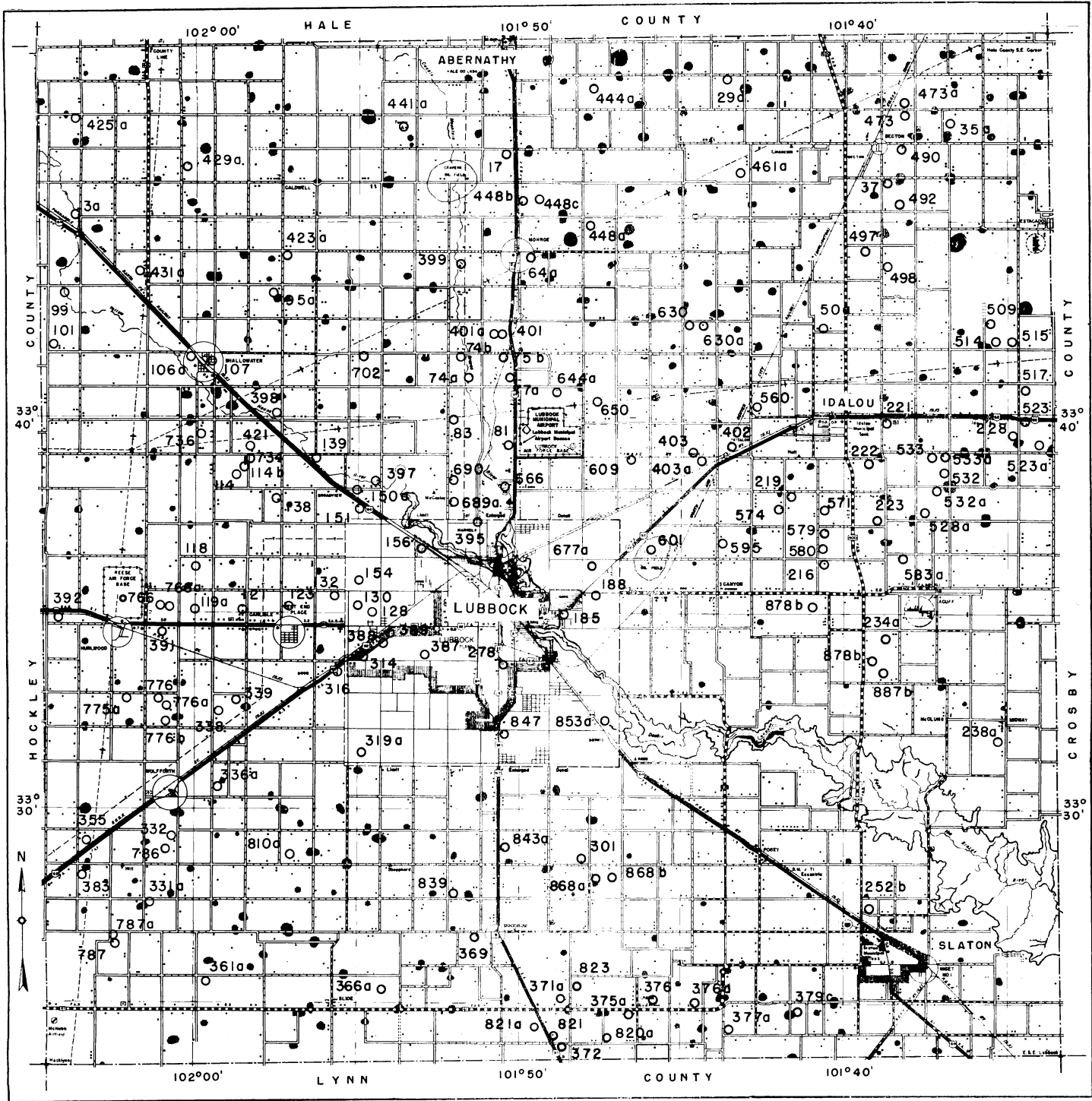

Base map by the Texas State Highway Department

LUBBOCK COUNTY

3a. Lat. 33°45', long. 102°03'. Depth 50 feet.

Date	Water level	Date	Water level	Date	Water level
Apr. 11, 1938	28.98	Oct. 19, 1938	28.01	Feb. 21, 1945	28.11
June 28	28.31	Jan. 16, 1939	28.48	Mar. 2, 1946	24.40
Aug. 10	27.53	Nov. 18, 1940	28.74	Mar. 3, 1948	23.78
Sept. 19	27.88	Feb. 9, 1944	28.00	Feb. 25, 1949	24.10

17. Lat. 33°46', long. 101°50'. Depth 157 feet.

Mar. 7, 1947	101.5	Feb. 13, 1950	107.30	Jan. 12, 1953	117.18
Feb. 22, 1949	105.45	Jan. 31, 1952	113.03		

29a. Lat. 33°48', long. 101°43'.

Mar. 9, 1949	102.36	Jan. 22, 1951	99.88	Jan. 8, 1953	104.17
Feb. 13, 1950	93.09	Jan. 26, 1952	104.02		

35a. Lat. 33°47', long. 101°36'.

Mar. 6, 1947	101.20	Feb. 22, 1949	95.90	Jan. 23, 1951	100.10
Feb. 23, 1948	94.03	Feb. 13, 1950	97.72	Jan. 8, 1953	108.49

37. Lat. 33°46', long. 101°38'. Depth 240 feet.

Mar. 12, 1937	73.15	Oct. 30, 1942	71.51	Jan. 15, 1948	75.77
Dec. 22	73.02	Jan. 28, 1943	71.11	Feb. 18	75.66
Jan. 10, 1939	73.13	Feb. 22, 1944	70.96	Feb. 22, 1949	77.52
Dec. 16	73.49	Feb. 9, 1945	71.43	Feb. 13, 1950	79.35
Nov. 19, 1940	74.37	Mar. 1, 1946	72.36	Jan. 23, 1951	82.47
Jan. 25, 1941	74.14	Jan. 21, 1947	74.16	Jan. 25, 1952	89.72
Mar. 23, 1942	71.60	Mar. 6	74.11	Jan. 8, 1953	88.72

50a. Lat. 33°42', long. 101°40'.

Mar. 6, 1947	73.50	Feb. 22, 1949	78.65	Jan. 26, 1952	88.20
Jan. 15, 1948	76.27	Feb. 13, 1950	80.95	Jan. 8, 1953	93.38
Feb. 23	76.48	Jan. 23, 1951	85.33		

LUBBOCK COUNTY

64a. Lat. 33°44', long. 101°49'. Depth 240 feet.

Date	Water level	Date	Water level	Date	Water level
Dec. 21, 1937	86.18	Mar. 13, 1940	85.49	Feb. 28, 1946	84.38
June 15, 1938	86.58	Nov. 13	86.14	Jan. 20, 1947	86.81
Oct. 18	86.21	Jan. 22, 1941	86.74	Mar. 19	86.55
Dec. 22	86.02	Dec. 27	84.44	Jan. 16, 1948	89.62
Mar. 7, 1939	85.72	Mar. 24, 1942	84.00	Feb. 23	88.24
June 23	87.94	Feb. 1, 1943	83.35	Feb. 22, 1949	91.33
Oct. 10	86.58	Feb. 9, 1944	82.54	Jan. 26, 1952	100.13
Dec. 17	85.83	Feb. 9, 1945	82.53	Jan. 8, 1953	100.00

74a. Lat. 33°40', long. 101°51'. Depth 52 feet.

June 30, 1938	32.06	Aug. 4, 1939	33.36	Mar. 24, 1942	30.50
Aug. 10	33.20	Oct. 10	34.35	Feb. 1, 1943	28.66
Sept. 23	33.98	Dec. 16	34.53	Feb. 9, 1944	31.21
Oct. 24	34.33	Mar. 13, 1940	34.60	Feb. 9, 1945	31.63
Dec. 22	34.40	July 10	34.81	Mar. 2, 1946	32.46
Jan. 28, 1939	34.23	Nov. 13	35.30	Jan. 20, 1947	33.03
Mar. 4	34.42	Jan. 22, 1941	35.13	Mar. 19	33.25
Apr. 3	34.50	Mar. 6	35.52	Feb. 24, 1949	36.09
June 30	32.32	June 3	29.41	Jan. 19, 1951	39.05
July 5	31.97	July 28	28.30	Jan. 12, 1953	46.80

74b. Lat. 33°41', long. 101°51'. Depth 52 feet.

June 30, 1939	35.06	Jan. 22, 1941	37.66	Feb. 1, 1943	29.40
July 5	34.41	Mar. 6	37.55	Feb. 9, 1944	33.02
Aug. 16	35.36	June 3	32.58	Feb. 9, 1945	33.40
Oct. 10	36.04	July 28	30.43	Mar. 2, 1946	34.04
Dec. 16	36.53	Mar. 23, 1942	31.95		
Mar. 13, 1940	36.89	Dec. 17	28.94		

75b. Lat. 33°41', long. 101°50'.

Mar. 7, 1947	58.68	Feb. 13, 1950	72.57	Jan. 12, 1953	86.35
Mar. 21, 1948	69.01	Jan. 19, 1951	77.56		
Mar. 7, 1949	71.35	Jan. 31, 1952	81.00		

LUBBOCK COUNTY

77a. Lat. 33°41', long. 101°50'. Depth 137 feet.

Date	Water level	Date	Water level	Date	Water level
Apr. 12, 1938	70.07	Dec. 16, 1939	70.36	Mar. 19, 1947	71.69
June 30	70.03	Mar. 13, 1940	70.36	Feb. 21, 1948	74.26
Sept. 23	69.92	Nov. 13	72.64	Feb. 24, 1949	78.89
Oct. 18	69.87	Feb. 1, 1943	69.97	Feb. 13, 1950	79.98
Mar. 7, 1939	69.87	Feb. 9, 1944	70.41	Jan. 19, 1951	82.85
June 23	69.83	Feb. 21, 1945	70.12	Jan. 31, 1952	85.04
Oct. 10	70.00	Mar. 2, 1946	72.21		

81. Lat. 33°39', long. 101°50'. Depth 160 feet.

Dec. 6, 1936	42.52	Nov. 13, 1940	46.14	Jan. 20, 1947	42.14
Dec. 21, 1937	42.25	Jan. 22, 1941	44.74	Mar. 20	42.26
Jan. 25, 1938	42.22	Mar. 6	45.15	Feb. 21, 1948	43.50
June 30	42.65	Dec. 27	39.78	Mar. 3, 1949	45.42
Dec. 23	42.33	Dec. 17, 1942	40.59	Feb. 14, 1950	46.00
Mar. 7, 1939	43.48	Feb. 1, 1943	40.00	Jan. 31, 1952	53.22
Oct. 10	45.98	Feb. 9, 1944	41.30	Jan. 15, 1953	55.55
Dec. 16	45.40	Feb. 23, 1945	40.52		
Mar. 13, 1940	44.92	Mar. 2, 1946	41.98		

83. Lat. 33°39', long. 101°52'. Depth 115 feet.

Mar. 8, 1947	45.40	Feb. 28, 1949	48.85	Jan. 19, 1951	51.66
Mar. 3, 1948	45.48	Feb. 13, 1950	48.58	Jan. 12, 1953	54.19

95a. Lat. 33°43', long. 101°56'.

Feb. 25, 1949	97.32	Jan. 30, 1952	102.97	Jan. 12, 1953	106.65
Feb. 17, 1950	97.42				

99. Lat. 33°43', long. 102°04'. Depth 108 feet.

June 22, 1937	34.20	Feb. 1, 1943	20.66	Feb. 28, 1949	33.39
Dec. 20	34.31	Feb. 9, 1944	25.53	Feb. 16, 1950	35.98
Jan. 26, 1938	34.35	Feb. 20, 1945	29.58	Jan. 25, 1952	36.00
Apr. 9	34.41	Mar. 2, 1946	31.83	Jan. 30	28.19
June 21	38.24	Jan. 20, 1947	31.12	Jan. 11, 1953	33.62
Nov. 18, 1940	39.67	Mar. 20	30.85		
Mar. 26, 1942	25.81	Mar. 3, 1948	32.44		

LUBBOCK COUNTY

101. Lat. 33°41', long. 102°04'. Depth 175 feet.

Date	Water level	Date	Water level	Date	Water level
June 22, 1937	62.55	Mar. 11, 1939	61.82	Feb. 20, 1945	62.22
Aug. 22	62.70	Aug. 15	62.38	Mar. 20, 1947	65.09
Dec. 20	62.64	Oct. 13	62.55	Feb. 28, 1949	69.50
Jan. 26, 1938	62.60	Mar. 13, 1940	61.88	Feb. 16, 1950	71.56
Apr. 9	62.31	Nov. 18	61.64	Jan. 25, 1951	76.90
June 21	62.52	Mar. 7, 1941	62.97	Jan. 30, 1952	81.42
Sept. 10	63.03	Feb. 1, 1943	61.68	Jan. 11, 1953	85.22

106a. Lat. 33°41', long. 102°00'.

Mar. 8, 1947	36.40	Feb. 25, 1949	40.89	Jan. 30, 1952	42.70
Mar. 3, 1948	38.67	Feb. 17, 1950	41.46	Jan. 11, 1953	45.31

107. Lat. 33°41', long. 101°59'. Depth 75 feet.

Aug. 9, 1937	50.60	Oct. 13, 1939	49.35	Feb. 20, 1945	45.38
Sept. 8	50.10	Mar. 13, 1940	49.38	Mar. 2, 1946	46.41
Jan. 26, 1938	50.04	Nov. 18	49.86	Mar. 8, 1947	44.46
Apr. 9	50.24	Mar. 7, 1941	49.88	Mar. 3, 1948	48.65
June 17	50.17	May 30	49.41	Feb. 25, 1949	49.33
Oct. 19	50.12	July 29	47.11	Feb. 17, 1950	51.35
Jan. 16, 1939	50.10	Mar. 26, 1942	45.73	Feb. 9, 1951	51.07
Mar. 11	50.17	July 28	45.58	Jan. 30, 1952	51.60
June 19	50.31	Feb. 1, 1943	43.56	Jan. 13, 1953	54.91
Aug. 15	49.51	Feb. 9, 1944	44.31		

114. Lat. 33°38', long. 101°58'. Depth 143 feet.

Mar. 8, 1947	58.98	Mar. 8, 1949	63.30	Jan. 26, 1951	65.62
Feb. 24, 1948	60.93	Feb. 16, 1950	64.96	Jan. 30, 1952	70.39

114b. Lat. 33°38', long. 101°58'.

Mar. 8, 1947	53.24	Feb. 28, 1949	59.20	Jan. 26, 1951	63.10
Feb. 24, 1948	58.50	Feb. 16, 1950	60.85		

LUBBOCK COUNTY

118. Lat. 33°36', long. 101°59'. Depth 100 feet.

Date	Water level	Date	Water level	Date	Water level
Dec. 7, 1936	81.44	Feb. 18, 1943	79.60	Mar. 1, 1948	87.54
Dec. 18, 1937	80.61	Feb. 4, 1944	79.56	Feb. 28, 1949	90.10
Dec. 23, 1938	80.67	Feb. 22, 1945	79.62	Feb. 16, 1950	90.93
Dec. 16, 1939	80.77	Feb. 28, 1946	81.81	Jan. 25, 1951	94.28
Mar. 7, 1941	81.56	Jan. 20, 1947	84.68	Jan. 31, 1952	97.34
Mar. 27, 1942	80.18	Mar. 20	84.89	Jan. 11, 1953	105.63
Dec. 18	79.66	Jan. 15, 1948	88.02		

119a. Lat. 33°35', long. 101°59'.

Mar. 8, 1947	78.41	Feb. 28, 1949	84.90	Jan. 25, 1951	89.14
Mar. 1, 1948	87.40	Feb. 16, 1950	85.68	Jan. 31, 1952	93.09

121. Lat. 33°35', long. 101°38'. Depth 208 feet.

May 20, 1937	74.75	Mar. 26, 1940	75.72	Feb. 20, 1945	73.47
Dec. 18	73.76	Nov. 18	77.00	Jan. 20, 1947	77.21
Apr. 12, 1938	74.67	Jan. 22, 1941	76.33	Mar. 20	80.13
Dec. 23	73.92	Mar. 7	77.84	Mar. 1, 1948	82.17
Mar. 14, 1939	74.16	Mar. 27, 1942	74.42	Feb. 28, 1949	82.00
June 26	79.60	Dec. 18	73.08	Feb. 16, 1950	82.64
Oct. 12	76.48	Feb. 18, 1943	72.70	Jan. 25, 1951	86.07
Dec. 16	75.59	Feb. 10, 1944	73.22	Jan. 31, 1952	89.53

123. Lat. 33°35', long. 101°57'. Depth 185 feet.

Dec. 8, 1936	62.35	Mar. 7, 1941	64.54	Mar. 20, 1947	65.75
Dec. 18, 1937	62.00	Mar. 27, 1942	62.20	Feb. 20, 1948	68.80
Dec. 23, 1938	62.80	Feb. 18, 1943	61.20	Feb. 28, 1949	75.95
Oct. 12, 1939	64.13	Feb. 10, 1944	61.70	Feb. 16, 1950	71.74
Dec. 16	63.72	Feb. 21, 1945	62.16	Jan. 25, 1951	75.73
Nov. 18, 1940	65.14	Feb. 28, 1946	63.82	Jan. 31, 1952	79.05
Jan. 22, 1941	66.08	Jan. 20, 1947	68.40	Jan. 12, 1953	80.30

LUBBOCK COUNTY

128. Lat. 33°36', long. 101°54'. Depth 160 feet.

Date	Water level	Date	Water level	Date	Water level
Dec. 8, 1936	42.09	Nov. 18, 1940	44.15	Feb. 18, 1943	37.57
Dec. 18, 1937	41.14	Jan. 22, 1941	43.09	Feb. 10, 1944	37.92
Dec. 23, 1938	40.68	Mar. 7	46.53	Feb. 21, 1945	39.25
Oct. 11, 1939	43.78	Mar. 27, 1942	39.28	Mar. 1, 1946	41.65
Dec. 16	41.96	Dec. 18	38.19	Jan. 28, 1947	45.26

130. Lat. 33°35', long. 101°55'. Depth 159 feet.

Mar. 1, 1946	41.65	Mar. 7, 1949	48.62	Jan. 31, 1952	56.60
Mar. 20, 1947	44.88	Feb. 15, 1950	49.89	Jan. 12, 1953	63.50
Feb. 20, 1948	51.12	Jan. 25, 1951	54.47		

132. Lat. 33°35', long. 101°55'. Depth 202 feet.

Mar. 20, 1947	46.69	Feb. 15, 1950	53.48	Jan. 12, 1953	66.52
Feb. 20, 1948	48.25	Jan. 25, 1951	57.20		
Mar. 7, 1949	52.33	Jan. 31, 1952	59.35		

138. Lat. 33°37', long. 101°57'. Depth 120 feet.

Apr. 13, 1937	44.28	Aug. 15, 1939	39.80	Feb. 1, 1943	34.54
Dec. 18	40.04	Oct. 13	39.86	Feb. 23, 1945	36.10
June 17, 1938	40.11	Dec. 16	39.83	Mar. 1, 1946	38.35
June 21	40.13	Mar. 13, 1940	39.92	Jan. 20, 1947	36.95
June 28	40.13	Apr. 4	39.90	Mar. 3, 1948	39.64
Sept. 10	39.60	Nov. 18	40.20	Mar. 8, 1949	44.93
Oct. 19	39.60	Mar. 7, 1941	40.41	Feb. 16, 1950	46.12
Dec. 23	39.59	July 29	37.83	Feb. 9, 1951	47.78
Mar. 10, 1939	39.58	Mar. 26, 1942	36.25	Jan. 1, 1952	53.63
June 19	39.78	Dec. 10	34.60	Jan. 11, 1953	57.70

IUBBOCK COUNTY

139. Lat. 33°38', long. 101°56'. Depth 120 feet.

Date	Water level	Date	Water level	Date	Water level
Apr. 13, 1937	27.24	Dec. 16, 1939	24.41	Feb. 22, 1945	23.77
Dec. 20	25.81	Mar. 13, 1940	24.88	Mar. 2, 1946	25.39
Jan. 26, 1938	25.85	Apr. 4	25.01	Jan. 20, 1947	25.48
Apr. 9	26.25	Nov. 18	26.07	Mar. 8	25.66
June 28	26.34	Mar. 7, 1941	26.23	Feb. 20, 1948	26.85
Sept. 10	25.69	May 30	24.91	Feb. 28, 1949	29.33
Jan. 16, 1939	25.82	July 29	22.23	Feb. 17, 1950	30.41
Mar. 10	25.86	Mar. 26, 1942	22.76	Jan. 26, 1951	34.21
June 19	24.04	Dec. 18	21.43	Jan. 30, 1952	35.48
Aug. 15	23.52	Feb. 1, 1943	21.43	Jan. 11, 1953	38.48
Oct. 13	23.88	Feb. 9, 1944	22.33		

150a. Lat. 33°38', long. 101°55'. Depth 50 feet.

June 28, 1938	27.58	Oct. 13, 1939	27.04	Mar. 26, 1942	22.72
Aug. 10	26.92	Dec. 16	27.03	July 28	22.12
Sept. 10	26.63	Mar. 13, 1940	27.10	Feb. 1, 1943	19.49
Oct. 19	26.98	July 10	27.29	Feb. 4, 1944	21.01
Jan. 16, 1939	27.18	Nov. 18	27.80	Feb. 22, 1945	23.42
Mar. 10	27.23	Mar. 7, 1941	27.96	Mar. 2, 1946	25.40
June 19	27.01	May 30	26.81	Mar. 20, 1947	27.65
Aug. 15	27.03	July 29	24.20	Feb. 20, 1948	28.00

151. Lat. 33°37', long. 101°54'. Depth 51 feet.

Apr. 13, 1937	29.31	July 12, 1939	26.90	July 4, 1942	22.20
Sept. 21	27.38	Aug. 15	26.90	Nov. 18	19.86
Jan. 26, 1938	27.34	Oct. 1	26.98	Feb. 1, 1943	19.31
Apr. 9	27.48	Dec. 16	27.03	Feb. 9, 1944	21.63
June 28	27.46	Mar. 13, 1940	27.14	Feb. 22, 1945	23.21
Aug. 10	26.78	July 10	27.34	Mar. 2, 1946	25.64
Sept. 10	26.68	Oct. 27	27.85	Mar. 20, 1947	26.80
Oct. 19	26.77	Nov. 18	27.96	Feb. 24, 1948	28.33
Dec. 6	26.86	Mar. 7, 1941	28.23	Feb. 28, 1949	32.32
Jan. 16, 1939	26.96	May 30	27.16	Feb. 15, 1950	36.57
Mar. 10	27.04	July 29	24.30	Jan. 26, 1951	39.97
June 19	26.88	Mar. 26, 1942	22.76		

LUBBOCK COUNTY

154. Lat. 33°35', long. 101°54'. Depth 160 feet.

Date	Water level	Date	Water level	Date	Water level
June 21, 1937	40.55	Mar. 7, 1941	40.33	Mar. 20, 1947	42.49
Dec. 18	38.71	Mar. 27, 1942	36.48	Mar. 7, 1949	48.53
Dec. 23, 1938	38.18	Dec. 18	34.96	Feb. 15, 1950	48.71
Oct. 11, 1939	39.41	Feb. 18, 1943	34.82	Jan. 25, 1951	51.14
Dec. 16	38.90	Feb. 10, 1944	35.43	Jan. 31, 1952	53.64
Nov. 18, 1940	40.34	Feb. 21, 1945	37.04	Jan. 12, 1953	61.60
Jan. 22, 1941	40.07	Mar. 1, 1946	39.47		

156. Lat. 33°36', long. 101°53'. Depth 152 feet.

Dec. 8, 1936	40.53	Mar. 7, 1941	42.17	Mar. 20, 1947	51.48
Dec. 18, 1937	40.21	July 29	40.40	Feb. 20, 1948	54.03
Dec. 23, 1938	39.98	Mar. 26, 1942	38.20	Feb. 28, 1949	58.62
June 26, 1939	40.58	Dec. 18	38.44	Feb. 15, 1950	59.24
Oct. 11	41.77	Feb. 1, 1943	37.81	Jan. 26, 1951	62.46
Dec. 16	41.23	Feb. 4, 1944	41.21	Jan. 30, 1952	62.43
Mar. 13, 1940	41.37	Feb. 23, 1945	41.16	Jan. 12, 1953	67.59
Nov. 18	43.38	Mar. 1, 1946	45.59		
Jan. 22, 1941	42.32	Jan. 20, 1947	51.26		

185. Lat. 33°35', long. 101°48'. Depth 100 feet.

Mar. 8, 1937	61.28	Sept. 9, 1938	61.18	Dec. 17, 1939	61.98
Sept. 22	61.29	Dec. 12	61.28	Mar. 22, 1940	62.04
Oct. 16	61.30	Jan. 16, 1939	61.26	Feb. 7, 1944	61.32
Jan. 26, 1938	61.16	Mar. 8	61.28	Feb. 21	61.92
Apr. 9	61.21	June 19	61.75	Mar. 1, 1946	63.29
June 17	61.41	July 20	61.87		
June 28	61.37	Oct. 10	62.00		

188. Lat. 33°35', long. 101°47'. Depth 185 feet.

Mar. 8, 1937	77.19	Jan. 25, 1941	77.57	Mar. 10, 1948	76.06
May 8	78.40	Mar. 6	77.46	Mar. 3, 1949	80.10
June 14, 1938	78.12	July 29	77.85	Feb. 17, 1950	77.64
Jan. 12, 1939	77.08	Dec. 18, 1942	75.97	Jan. 23, 1951	78.11
Mar. 7	77.47	Feb. 3, 1944	75.18	Feb. 1, 1952	79.30
Dec. 17	77.57	Mar. 1, 1945	74.29	Jan. 10, 1953	82.92
Feb. 28, 1940	76.92	Mar. 2, 1946	77.67		
Nov. 19	78.38	Jan. 17, 1947	75.98		

LUBBOCK COUNTY

216. Lat. 33°36', long. 101°40'. Depth 78 feet.

Date	Water level	Date	Water level	Date	Water level
Feb. 3, 1937	52.28	Mar. 19, 1947	47.90	Jan. 23, 1951	51.92
Feb. 22, 1944	46.62	Feb. 19, 1948	50.68	Jan. 28, 1952	56.70
Feb. 26, 1945	46.90	Feb. 23, 1949	53.15	Jan. 9, 1953	62.19
Mar. 1, 1946	47.23	Feb. 14, 1950	51.90		

219. Lat. 33°38', long. 101°41'. Depth 193 feet.

Feb. 5, 1937	43.00	July 29, 1941	41.24	Mar. 19, 1947	41.87
Dec. 22	42.80	Mar. 23, 1942	38.16	Jan. 15, 1948	43.89
Mar. 7, 1939	42.56	Dec. 18	34.02	Feb. 23, 1949	47.13
Oct. 10	44.74	Jan. 28, 1943	33.78	Feb. 14, 1950	46.12
Dec. 17	43.82	Feb. 22, 1944	35.42	Jan. 28, 1952	53.42
Nov. 19, 1940	45.52	Feb. 20, 1945	37.43	Jan. 9, 1953	56.60
Jan. 25, 1941	44.87	Feb. 28, 1946	39.55		
Mar. 6	44.72	Jan. 17, 1947	42.38		

221. Lat. 33°39', long. 101°38'. Depth 59 feet.

June 23, 1937	54.90	Dec. 17, 1939	55.93	July 31, 1942	52.28
Sept. 10	55.49	Nov. 19, 1940	56.19	Jan. 28, 1943	50.13
Jan. 24, 1938	55.87	Jan. 25, 1941	56.21	Feb. 8, 1944	50.33
Mar. 7, 1939	55.92	Mar. 6	56.25	Feb. 9, 1945	52.12
June 23	55.97	July 29	53.59	Feb. 28, 1946	54.63
Sept. 30	55.98	Mar. 23, 1942	51.97		

222. Lat. 33°38', long. 101°39'. Depth 250 feet.

Feb. 5, 1937	53.66	Mar. 6, 1941	53.13	Feb. 18, 1948	52.16
Apr. 14, 1938	53.25	Mar. 23, 1942	50.55	Feb. 24, 1949	54.04
June 14	53.23	July 31	50.12	June 22	55.20
Sept. 30	53.12	Jan. 28, 1943	48.61	Feb. 14, 1950	54.34
Mar. 7, 1939	53.08	Feb. 8, 1944	47.50	Jan. 23, 1951	57.52
June 23	53.06	Feb. 20, 1945	48.10	Jan. 28, 1952	59.46
Oct. 10	53.08	Feb. 28, 1946	48.58	Jan. 9, 1953	64.07
Dec. 17	53.04	Jan. 17, 1947	52.10		
Mar. 22, 1940	53.02	Mar. 19	51.05		

LUBBOCK COUNTY

223. Lat. 33°37', long. 101°38'. Depth 64 feet.

Date	Water level	Date	Water level	Date	Water level
Feb. 4, 1937	46.80	Nov. 19, 1940	47.40	Feb. 28, 1946	42.36
June 14, 1938	47.41	Jan. 25, 1941	47.36	Jan. 17, 1947	42.21
Aug. 9	47.46	Mar. 6	47.40	Mar. 19	42.24
Jan. 6, 1939	47.42	July 29	44.45	Feb. 18, 1948	42.51
Mar. 8	47.39	Mar. 23, 1942	42.85	Feb. 23, 1949	42.61
June 30	47.42	July 31	43.44	Feb. 14, 1950	39.74
Oct. 10	47.65	Jan. 28, 1943	42.63	Jan. 23, 1951	41.78
Dec. 16	47.40	Feb. 8, 1944	42.61	Jan. 28, 1952	43.80
Mar. 22, 1940	47.46	Feb. 20, 1945	42.67	Jan. 9, 1953	44.25

228. Lat. 33°39', long. 101°34'. Depth 83 feet.

Feb. 3, 1937	68.39	June 23, 1939	67.87	July 29, 1941	66.67
Sept. 10	68.24	Sept. 30	67.84	Mar. 23, 1942	65.53
Jan. 24, 1938	68.13	Dec. 17	67.80	July 31	65.35
Apr. 14	68.09	Mar. 22, 1940	67.79	Jan. 28, 1943	65.24
June 14	68.06	Nov. 19	67.87	Feb. 8, 1944	65.08
Aug. 9	67.99	Jan. 25, 1941	67.85	Feb. 20, 1945	65.32
Sept. 30	67.92	Mar. 6	67.86		
Mar. 7, 1939	67.91	June 3	67.88		

234a. Lat. 33°34', long. 101°38'.

Mar. 11, 1947	58.06	Feb. 14, 1950	62.35	Jan. 9, 1953	69.24
Mar. 10, 1948	59.65	Jan. 23, 1951	60.82		
Feb. 23, 1949	61.00	Jan. 28, 1952	64.39		

238a. Lat. 33°31', long. 101°35'.

Mar. 9, 1949	53.04	Feb. 13, 1950	52.32	Jan. 23, 1951	51.70
--------------	-------	---------------	-------	---------------	-------

252b. Lat. 33°27', long. 101°39'.

Mar. 8, 1939	99.08	Dec. 16, 1939	99.44	July 31, 1942	98.70
June 30	99.21	Mar. 6, 1940	100.06	Jan. 28, 1943	98.41
Oct. 11	99.41	Mar. 24, 1942	98.95		

LUBBOCK COUNTY

278. Lat. 33°33', long. 101°50'. Depth 100 feet.

Date	Water level	Date	Water level	Date	Water level
Mar. 8, 1937	78.12	Mar. 8, 1939	77.58	July 29, 1941	78.88
Sept. 28	78.15	June 30	77.64	Mar. 28, 1942	77.69
Apr. 30, 1938	77.82	Oct. 10	78.11	July 31	77.52
June 30	77.88	Dec. 17	78.13	Jan. 28, 1943	77.05
Oct. 26	78.10	Nov. 19, 1940	79.68		
Dec. 12	77.90	Mar. 6, 1941	79.78		

301. Lat. 33°28', long. 101°47'. Depth 70 feet.

Jan. 6, 1937	57.70	Mar. 6, 1941	57.33	Mar. 2, 1948	54.00
Jan. 6, 1939	56.56	Feb. 16, 1943	50.20	Mar. 3, 1949	59.44
Mar. 8	56.52	Feb. 7, 1944	49.58	Feb. 16, 1950	59.09
June 30	56.81	Feb. 27, 1945	50.13	Jan. 28, 1952	68.15
Oct. 11	57.17	Feb. 28, 1946	51.82	Jan. 10, 1953	70.41
Dec. 16	56.77	Jan. 21, 1947	53.57		
Nov. 19, 1940	57.53	Mar. 19	53.11		

314. Lat. 33°33', long. 101°54'. Depth 150 feet.

May 27, 1937	50.95	Oct. 11, 1939	44.09	Mar. 2, 1946	45.30
June 21	47.99	Jan. 16, 1940	44.08	Mar. 26, 1947	47.10
Dec. 23	45.19	Nov. 20, 1940	47.89	Feb. 26, 1948	48.04
Jan. 26, 1938	45.06	Mar. 7, 1941	45.56	Mar. 4, 1949	51.35
June 20	46.82	July 28	45.32	Feb. 15, 1950	52.92
July 22	45.01	Dec. 18, 1942	46.44	Jan. 30, 1951	51.75
Jan. 26, 1939	44.61	Feb. 18, 1943	44.86	Feb. 1, 1952	52.90
Mar. 10	44.42	Feb. 10, 1944	44.18	Jan. 11, 1953	55.50
Aug. 9	44.10	Feb. 27, 1945	43.12		

316. Lat. 33°33', long. 101°55'. Depth 123 feet.

May 27, 1937	63.40	Jan. 6, 1939	62.39	Mar. 2, 1946	60.37
June 21	62.86	Mar. 27, 1942	61.50	Mar. 20, 1947	61.54
Aug. 2	63.12	Feb. 18, 1943	61.15	Mar. 7, 1949	64.02
Apr. 26, 1938	62.48	Feb. 29, 1945	60.62	Feb. 17, 1950	64.33

LUBBOCK COUNTY

319a. Lat. 33°31', long. 101°54'.

Date	Water level	Date	Water level	Date	Water level
Mar. 21, 1947	75.72	Mar. 4, 1949	77.51	Feb. 1, 1952	84.10
Mar. 2, 1948	82.16	Feb. 15, 1950	79.00	Jan. 11, 1953	89.02

331a. Lat. 33°27', long. 102°01'.

Oct. 27, 1938	73.02	Mar. 25, 1942	70.80	Mar. 4, 1949	74.03
Jan. 26, 1939	73.11	July 30	71.09	Feb. 16, 1950	75.46
Aug. 9	73.10	Feb. 18, 1943	71.00	Jan. 30, 1951	79.22
Jan. 16, 1940	73.16	Feb. 10, 1944	70.60	Jan. 29, 1952	82.13
Jan. 22, 1941	73.45	Mar. 5, 1945	70.78	Jan. 10, 1953	87.50
Mar. 7	73.63	Mar. 19, 1947	71.77		
July 28	72.32	Feb. 26, 1948	72.44		

332. Lat. 33°29', long. 102°00'.

Dec. 14, 1936	95.64	Jan. 26, 1938	95.32	Mar. 20, 1947	97.42
July 19, 1937	95.42	Jan. 26, 1939	95.77		
Aug. 2	95.40	Oct. 11	97.34		

336a. Lat. 33°30', long. 101°59'. Depth 198 feet.

Apr. 27, 1938	77.95	July 31, 1940	78.82	Feb. 18, 1943	76.58
July 22	78.90	Nov. 20	78.93	Feb. 10, 1944	76.47
Oct. 27	78.62	Jan. 22, 1941	78.94	Feb. 27, 1945	76.62
Jan. 26, 1939	78.57	Mar. 7	79.00	Mar. 2, 1946	77.28
Aug. 9	78.65	July 28	77.27	Jan. 21, 1947	79.52
Oct. 11	78.68	Mar. 25, 1942	76.55		
Jan. 16, 1940	78.70	July 30	76.84		

338. Lat. 33°32', long. 101°59'. Depth 160 feet.

Mar. 21, 1947	64.91	Mar. 4, 1949	69.32	Jan. 30, 1951	74.66
Mar. 1, 1948	66.51	Feb. 16, 1950	70.00	Jan. 11, 1953	84.16

LUBBOCK COUNTY

339. Lat. 33°32', long. 101°58'. Depth 162 feet.

Date	Water level	Date	Water level	Date	Water level
May 18, 1937	62.18	Mar. 7, 1941	63.45	Jan. 21, 1947	63.56
Dec. 23	61.73	Mar. 25, 1942	61.17	Mar. 20	63.11
Jan. 4, 1939	61.80	Dec. 18	60.17	Mar. 1, 1948	66.08
Oct. 11	62.83	Feb. 18, 1943	59.84	Mar. 4, 1949	67.24
Jan. 16, 1940	62.46	Feb. 10, 1944	59.53	Feb. 16, 1950	67.75
Nov. 20	63.84	Feb. 21, 1945	59.46	Jan. 30, 1951	71.31
Jan. 22, 1941	63.50	Mar. 2, 1946	59.50	Jan. 11, 1953	80.22

355. Lat. 33°29', long. 102°03'. Depth 188 feet.

May 14, 1937	83.98	Jan. 22, 1941	84.80	Mar. 20, 1947	83.85
June 21	83.90	Mar. 7	85.69	Jan. 15, 1948	85.00
Dec. 23	83.69	July 28	84.61	Mar. 1	84.76
Jan. 25, 1938	83.64	Mar. 25, 1942	83.34	Mar. 8, 1949	85.68
Apr. 26	87.50	Feb. 18, 1943	82.95	Feb. 16, 1950	86.16
Jan. 6, 1939	84.02	Feb. 10, 1944	82.58	Jan. 30, 1951	88.00
Oct. 11	85.42	Feb. 27, 1945	82.03	Jan. 29, 1952	93.03
Jan. 16, 1940	84.64	Feb. 28, 1946	82.51	Jan. 10, 1953	100.10
Nov. 20	85.61	Jan. 21, 1947	84.15		

361a. Lat. 33°25', long. 101°59'.

Mar. 8, 1949	85.12	Jan. 30, 1951	87.60	Jan. 10, 1953	92.20
Feb. 16, 1950	85.70	Jan. 29, 1952	93.53		

366a. Lat. 33°25', long. 101°59'.

Mar. 9, 1949	91.19	Jan. 24, 1951	92.05	Jan. 10, 1953	94.80
Feb. 16, 1950	91.39	Jan. 29, 1952	92.73		

369. Lat. 33°26', long. 101°51'. Depth 98 feet.

Dec. 22, 1936	80.97	Feb. 16, 1943	74.40	Mar. 19, 1947	79.72
Jan. 21, 1938	80.87	Feb. 7, 1944	76.10	Mar. 2, 1948	82.26
Dec. 12	80.50	Feb. 27, 1945	75.91	Mar. 3, 1949	86.42
Nov. 19, 1940	81.07	Feb. 28, 1946	76.92	Mar. 16, 1950	86.25
Mar. 27, 1942	74.72	Jan. 21, 1947	80.01	Jan. 24, 1951	88.15

LUBBOCK COUNTY

371a. Lat. 33°25', long. 101°48'.

Date	Water level	Date	Water level	Date	Water level
Mar. 10, 1947	86.32	Feb. 15, 1950	90.68	Jan. 9, 1953	101.80
Mar. 2, 1948	88.47	Jan. 24, 1951	94.27		
Mar. 3, 1949	92.20	Jan. 29, 1952	97.68		

372. Lat. 33°23', long. 101°48'. Depth 135 feet.

May 12, 1937	89.28	Oct. 26, 1938	88.50	Mar. 3, 1949	95.94
Sept. 28	88.32	Dec. 12	88.33	Feb. 15, 1950	95.25
Jan. 21, 1938	88.05	Feb. 7, 1944	92.20	Jan. 24, 1951	96.81
Apr. 30	89.48	Feb. 27, 1945	92.28		
July 22	88.52	Mar. 19, 1947	91.26		

375a. Lat. 33°24', long. 101°46'.

Mar. 11, 1947	78.40	Feb. 15, 1950	82.98	Jan. 9, 1953	94.50
Mar. 2, 1948	80.73	Jan. 24, 1951	86.17		
Mar. 3, 1949	83.43	Jan. 29, 1952	90.34		

376. Lat. 33°24', long. 101°45'. Depth 98 feet.

Jan. 6, 1937	93.06	Oct. 11, 1939	93.10	Feb. 16, 1943	90.78
Jan. 6, 1939	92.81	Dec. 16	92.95	Feb. 7, 1944	90.21
Mar. 8	92.78	Mar. 27, 1942	91.75	Feb. 27, 1945	89.95
June 30	93.32	July 31	91.42	Feb. 28, 1946	91.03

376a. Lat. 33°24', long. 101°44'.

Mar. 10, 1947	84.37	Feb. 15, 1950	82.47	Jan. 6, 1953	98.45
Mar. 3, 1949	80.55	Jan. 29, 1952	91.76		

377a. Lat. 33°24', long. 101°43'.

Mar. 11, 1947	70.42	Feb. 15, 1950	76.13	Jan. 9, 1953	93.70
Mar. 8, 1949	76.48	Jan. 29, 1952	85.86		

LUBBOCK COUNTY

379c. Lat. 33°24', long. 101°41'.

Date	Water level	Date	Water level	Date	Water level
Mar. 11, 1947	62.37	Feb. 15, 1950	68.23	Jan. 9, 1953	88.76
Mar. 2, 1948	63.40	Jan. 24, 1951	73.50		
Mar. 3, 1949	68.92	Jan. 29, 1952	79.82		

383. Lat. 33°28', long. 102°03'. Depth 87 feet.

July 1, 1937	73.45	Jan. 16, 1940	73.64	Feb. 28, 1946	71.95
Aug. 2	73.32	Nov. 20	73.79	Mar. 19, 1947	72.13
Jan. 25, 1938	73.28	Mar. 25, 1942	72.23	Mar. 1, 1948	75.44
Aug. 14, 1939	73.48	Feb. 10, 1944	71.70	Mar. 4, 1949	74.25
Oct. 11	73.52	Mar. 5, 1945	71.52		

387. Lat. 33°34', long. 101°53'. Depth 51 feet.

July 20, 1937	42.41	Aug. 14, 1939	40.12	June 3, 1941	42.73
Aug. 12	41.92	Oct. 11	40.45	July 28	41.15
Sept. 28	41.16	Jan. 16, 1940	41.07	Mar. 27, 1942	37.32
Oct. 18	40.79	Mar. 26	41.43	July 4	37.32
Jan. 26, 1938	40.14	July 31	42.25	Nov. 18	36.30
Apr. 26	39.88	Oct. 27	42.84	Feb. 18, 1943	35.00
June 22	40.05	Nov. 19	43.01	Feb. 10, 1944	36.24
July 22	40.01	Jan. 22, 1941	43.37	Feb. 27, 1945	37.51
Oct. 27	39.92	Mar. 6	43.43	Mar. 1, 1946	40.15
Jan. 26, 1939	40.09	May 30	43.07	Feb. 26, 1948	37.13

388. Lat. 33°34', long. 101°54'. Depth 57 feet.

July 20, 1937	20.81	July 22, 1938	22.01	Mar. 6, 1941	29.62
Aug. 2	20.00	Jan. 26, 1939	23.41	May 30	22.31
Sept. 21	19.93	June 24	24.32	June 3	21.48
Oct. 18	20.23	Aug. 14	24.56	July 28	19.31
Jan. 26, 1938	21.85	Oct. 11	25.29	Mar. 27, 1942	20.32
Apr. 26	22.84	Mar. 26, 1940	27.00	Feb. 10, 1944	21.72
June 20	22.76	Nov. 19	29.19	Feb. 27, 1945	24.58
June 22	22.50	Jan. 22, 1941	29.43		

LUBBOCK COUNTY

389. Lat. 33°34', long. 101°54'. Depth 55 feet.

Date	Water level	Date	Water level	Date	Water level
July 20, 1937	22.18	July 22, 1938	22.41	June 3, 1941	21.64
Aug. 2	21.89	Jan. 26, 1939	23.90	Mar. 27, 1942	21.31
Sept. 21	20.73	Oct. 11	26.36	Dec. 18	18.70
Oct. 18	21.03	Mar. 26, 1940	28.12	Feb. 18, 1943	19.44
Jan. 26, 1938	23.06	July 31	29.50	Feb. 10, 1944	24.12
Apr. 26	24.22	Nov. 19	30.48	Feb. 27, 1945	25.41
June 20	22.85	Jan. 22, 1941	30.60	Mar. 7, 1949	36.83
June 22	22.52	May 30	21.57		

391. Lat. 33°34', long. 102°01'. Depth 85 feet.

July 21, 1937	78.36	Feb. 6, 1939	77.86	July 28, 1941	79.01
Sept. 7	78.27	Mar. 14	77.94	Mar. 25, 1942	77.74
Jan. 25, 1938	78.82	June 26	78.05	Feb. 18, 1943	76.75
Apr. 12	77.84	Oct. 12	78.24	Feb. 10, 1944	76.77
June 22	77.78	Mar. 26, 1940	78.53		
Sept. 9	77.76	Nov. 18	78.96		

392. Lat. 33°34', long. 102°04'. Depth 95 feet.

July 21, 1937	92.54	Mar. 25, 1942	91.74	Mar. 1, 1948	90.59
Sept. 7	93.25	Feb. 18, 1943	91.20	Feb. 28, 1949	93.49
Jan. 25, 1938	92.51	Feb. 10, 1944	91.53	Feb. 16, 1950	94.40
June 22	92.41	Feb. 20, 1945	91.05	Jan. 26, 1951	89.80
Feb. 6, 1939	92.27	Feb. 28, 1946	89.72	Jan. 31, 1952	99.95
Mar. 14	92.18	Jan. 20, 1947	90.25	Jan. 11, 1953	103.60
Oct. 12	92.16	Mar. 20	90.02		

395. Lat. 33°37', long. 101°51'. Depth 125 feet.

Sept. 21, 1937	44.91	Aug. 15, 1939	53.07	Feb. 8, 1944	40.36
Oct. 16	44.46	Mar. 13, 1940	46.15	Feb. 23, 1945	45.20
Jan. 26, 1938	44.04	Nov. 19	50.43	Feb. 20, 1948	51.78
Apr. 9	43.96	Jan. 22, 1941	48.00	Feb. 28, 1949	54.83
June 17	43.89	Mar. 7	47.83	Feb. 15, 1950	54.73
Mar. 10, 1939	43.95	Dec. 17, 1942	41.94		
June 19	53.00	Feb. 1, 1943	42.12		

LUBBOCK COUNTY

397. Lat. 33°38', long. 101°54'. Depth 25 feet.

Date	Water level	Date	Water level	Date	Water level
Sept. 8, 1937	16.67	June 19, 1939	16.44	Mar. 7, 1941	17.01
Jan. 26, 1938	17.00	Aug. 15	16.96	May 30	14.58
Apr. 9	17.19	Oct. 13	16.83	July 29	13.24
June 28	16.74	Dec. 16	16.83	Mar. 26, 1942	12.94
Sept. 10	16.39	Mar. 13, 1940	16.94	Feb. 1, 1943	10.10
Oct. 19	16.73	Apr. 4	16.95	Feb. 4, 1944	12.02
Jan. 16, 1939	16.99	July 10	17.20	Feb. 9, 1945	13.31
Mar. 10	17.11	Nov. 18	18.94	Mar. 2, 1946	16.07

398. Lat. 33°39', long. 101°57'. Depth 56 feet.

Sept. 8, 1937	15.24	Oct. 13, 1939	13.69	Feb. 9, 1944	12.38
Jan. 26, 1938	15.36	Dec. 16	13.93	Oct. 5	12.63
Apr. 9	15.54	Mar. 13, 1940	14.29	Feb. 9, 1945	12.60
June 21	14.23	July 10	14.71	Mar. 2, 1946	15.82
Sept. 10	15.26	Nov. 18	15.43	Mar. 21, 1947	14.66
Oct. 19	15.43	Mar. 7, 1941	15.52	Feb. 28, 1949	18.24
Jan. 16, 1939	15.58	May 30	11.65	Feb. 17, 1950	18.96
Mar. 10	15.70	July 29	11.62	Jan. 26, 1951	20.40
June 19	14.72	Mar. 26, 1942	11.90	Jan. 30, 1952	21.47
Aug. 15	13.67	Feb. 1, 1943	10.29		

399. Lat. 33°43', long. 101°51'. Depth 56 feet.

Sept. 9, 1937	42.72	Oct. 24, 1938	41.89	July 20, 1939	41.53
Jan. 25, 1938	42.13	Dec. 22	41.89	Aug. 16	41.52
Apr. 12	42.24	Jan. 28, 1939	41.86	Oct. 10	41.61
June 30	42.18	Mar. 4	41.93	Dec. 16	41.54
Aug. 10	41.77	Apr. 3	42.01	Mar. 13, 1940	41.52
Sept. 23	41.86	June 30	41.80	July 10	41.75

401. Lat. 33°42', long. 101°50'. Depth 79 feet.

Sept. 9, 1937	71.14	Dec. 16, 1939	70.55	Feb. 9, 1944	67.96
Jan. 25, 1938	71.00	Mar. 13, 1940	70.53	Feb. 9, 1945	67.66
Apr. 12	70.97	July 10	70.54	Mar. 2, 1946	68.44
June 30	70.95	Nov. 13	70.88	Mar. 19, 1947	72.60
Jan. 28, 1939	70.71	Jan. 22, 1941	70.87	Feb. 21, 1948	79.19
Mar. 4	70.58	Mar. 6	70.88	Feb. 24, 1949	75.57
June 16	70.62	July 28	70.39	Feb. 13, 1950	76.77
July 10	70.64	Mar. 24, 1942	69.24	Jan. 19, 1951	80.64
Aug. 16	70.70	July 28	68.95		
Oct. 10	70.64	Feb. 1, 1943	68.52		

LUBBOCK COUNTY

401a. Lat. 33°42', long. 101°50'.

Date	Water level	Date	Water level	Date	Water level
Feb. 24, 1949	75.57	Jan. 19, 1951	80.64	Jan. 12, 1953	88.50
Feb. 13, 1950	76.77	Jan. 31, 1952	84.70		

402. Lat. 33°39', long. 101°43'. Depth 57 feet.

Sept. 10, 1937	38.37	Dec. 17, 1939	39.44	Dec. 18, 1942	30.34
Jan. 24, 1938	38.24	Mar. 22, 1940	39.68	Jan. 28, 1943	30.58
Apr. 14	38.34	Nov. 19	40.71	Feb. 7, 1944	31.62
June 14	38.57	Jan. 25, 1941	41.00	Feb. 9, 1945	31.70
Sept. 30	38.00	Mar. 6	41.12	Mar. 1, 1946	36.13
Mar. 7, 1939	38.23	June 3	39.40	Feb. 18, 1948	40.86
June 23	38.42	July 29	36.45	Feb. 24, 1949	43.54
Sept. 30	39.03	Mar. 20, 1942	34.88	Feb. 13, 1950	43.87

403. Lat. 33°38', long. 101°44'.

Sept. 10, 1937	39.60	Dec. 17, 1939	39.80	Jan. 28, 1943	33.18
Jan. 24, 1938	38.84	Mar. 22, 1940	40.41	Feb. 7, 1944	34.91
Apr. 14	38.56	Nov. 19	42.42	Feb. 7, 1945	34.86
June 14	38.78	Jan. 25, 1941	42.16	Mar. 1, 1946	37.13
Mar. 7, 1939	38.37	Mar. 6	42.06	Jan. 17, 1947	40.05
June 23	39.11	July 29	39.23	Mar. 19	39.61
Sept. 30	40.00	Mar. 23, 1942	35.86	Feb. 18, 1948	40.53

403a. Lat. 33°38', long. 101°44'.

Feb. 24, 1949	43.74	Jan. 24, 1951	45.20	Jan. 8, 1953	50.80
Feb. 13, 1950	44.50	Feb. 1, 1952	47.00		

421. Lat. 33°39', long. 101°58'.

Mar. 20, 1947	37.46	Mar. 8, 1949	42.80	Jan. 11, 1953	60.60
Mar. 3, 1948	39.05	Jan. 26, 1951	47.41		

423a. Lat. 33°44', long. 101°56'.

Mar. 7, 1947	99.55	Feb. 9, 1951	101.11	Jan. 12, 1953	107.11
Feb. 25, 1949	98.73	Jan. 30, 1952	104.17		

LUBBOCK COUNTY

425a. Lat. 33°47', long. 102°03'.

Date	Water level	Date	Water level	Date	Water level
Mar. 8, 1949	83.48	Jan. 25, 1951	85.92	Jan. 13, 1953	90.32
Feb. 15, 1950	84.70	Jan. 30, 1952	88.23		

429a. Lat. 33°46', long. 102°00'.

Date	Water level	Date	Water level	Date	Water level
Mar. 3, 1949	127.11	Jan. 25, 1951	128.69	Jan. 13, 1953	132.13
Feb. 16, 1950	128.04	Jan. 30, 1952	130.12		

431a. Lat. 33°43', long. 102°01'.

Date	Water level	Date	Water level	Date	Water level
Mar. 8, 1949	102.10	Jan. 25, 1951	99.87	Jan. 13, 1953	104.55
Feb. 16, 1950	97.16	Jan. 30, 1952	101.23		

441a. Lat. 33°47', long. 101°53'.

Date	Water level	Date	Water level	Date	Water level
Mar. 8, 1949	125.58	Jan. 31, 1952	132.25	Jan. 12, 1953	136.00
Feb. 17, 1950	128.84				

444a. Lat. 33°48', long. 101°47'.

Date	Water level	Date	Water level	Date	Water level
Mar. 9, 1949	112.82	Jan. 22, 1951	117.04	Jan. 8, 1953	125.28
Feb. 13, 1950	113.85	Jan. 26, 1952	115.77		

448a. Lat. 33°44', long. 101°48'.

Date	Water level	Date	Water level	Date	Water level
Mar. 7, 1947	97.58	Feb. 22, 1949	103.63	Jan. 8, 1953	110.02
Feb. 23, 1948	100.45	Feb. 13, 1950	110.82		

448b. Lat. 33°45', long. 101°50'.

Date	Water level	Date	Water level	Date	Water level
Mar. 7, 1947	99.43	Feb. 22, 1949	110.70	Jan. 19, 1951	119.91
Feb. 23, 1948	106.80	Feb. 13, 1950	114.29		

448c. Lat. 33°45', long. 101°44'.

Date	Water level	Date	Water level	Date	Water level
Mar. 7, 1947	99.47	Feb. 22, 1949	105.24	Jan. 19, 1951	113.57
Feb. 23, 1948	102.27	Feb. 13, 1950	108.01		

LUBBOCK COUNTY

461a. Lat. 33°46', long. 101°43'.

Date	Water level	Date	Water level	Date	Water level
Mar. 9, 1949	92.45	Jan. 24, 1951	97.55	Jan. 8, 1953	105.55
Feb. 13, 1950	94.18	Jan. 28, 1952	105.69		

473. Lat. 33°47', long. 101°38'. Depth 300 feet.

Mar. 6, 1947	94.45	Feb. 13, 1950	98.48	Jan. 8, 1953	109.00
Feb. 23, 1948	93.48	Jan. 22, 1951	101.42		
Feb. 22, 1949	95.24	Jan. 25, 1952	104.91		

473a. Lat. 33°47', long. 101°38'.

Mar. 6, 1947	89.48	Feb. 13, 1950	96.76	Jan. 8, 1953	106.40
Feb. 18, 1948	90.77	Jan. 22, 1951	100.20		
Feb. 22, 1949	93.24	Jan. 25, 1952	106.49		

490. Lat. 33°46', long. 101°38'.

Mar. 7, 1947	92.44	Feb. 13, 1950	88.84	Jan. 8, 1953	100.39
Feb. 18, 1948	84.36	Jan. 23, 1951	91.38		
Feb. 22, 1949	86.05	Jan. 25, 1952	94.87		

492. Lat. 33°45', long. 101°38'. Depth 257 feet.

Oct. 10, 1944	76.00	Feb. 22, 1949	78.98	Jan. 25, 1952	91.24
Mar. 12, 1947	75.83	Feb. 13, 1950	80.84	Jan. 8, 1953	89.91
Feb. 18, 1948	79.50	Jan. 23, 1951	85.41		

497. Lat. 33°44', long. 101°39'.

Mar. 6, 1947	92.73	Feb. 13, 1950	92.57	Jan. 8, 1953	101.09
Feb. 18, 1948	89.03	Jan. 23, 1951	93.95		
Feb. 22, 1949	90.63	Jan. 25, 1952	99.34		

LUBBOCK COUNTY

498. Lat. 33°44', long. 101°38'. Depth 262 feet.

Date	Water level	Date	Water level	Date	Water level
Jan. 25, 1941	87.20	Feb. 18, 1948	90.98	Jan. 25, 1952	100.43
Feb. 22, 1944	84.43	Feb. 22, 1949	92.15	Jan. 8, 1953	104.47
Feb. 9, 1945	85.00	Feb. 13, 1950	93.90		
Mar. 6, 1947	88.25	Jan. 23, 1951	96.96		

509. Lat. 33°42', long. 101°35'. Depth 247 feet.

Mar. 6, 1947	83.70	Feb. 14, 1950	86.33	Jan. 8, 1953	97.27
Feb. 18, 1948	83.22	Jan. 23, 1951	91.59		
Feb. 24, 1949	85.49	Jan. 25, 1952	93.13		

514. Lat. 33°41', long. 101°35'. Depth 245 feet.

Mar. 6, 1947	83.04	Feb. 24, 1949	87.19	Jan. 23, 1951	91.75
Feb. 18, 1948	84.94	Feb. 14, 1950	89.91	Jan. 8, 1953	96.69

515. Lat. 33°41', long. 101°34'. Depth 244 feet.

Mar. 6, 1947	87.09	Feb. 14, 1950	94.16	Jan. 8, 1953	103.52
Feb. 18, 1948	89.46	Jan. 23, 1951	96.27		
Feb. 24, 1949	92.39	Jan. 25, 1952	99.21		

517. Lat. 33°40', long. 101°34'.

Mar. 12, 1947	93.48	Jan. 23, 1951	102.12	Jan. 8, 1953	110.80
Feb. 14, 1950	98.64	Jan. 25, 1952	106.20		

523. Lat. 33°39', long. 101°34'.

Mar. 6, 1947	80.00	Feb. 24, 1949	82.78	Jan. 25, 1952	93.68
Mar. 9, 1948	86.93	Feb. 14, 1950	83.06	Jan. 8, 1953	98.93

LUBBOCK COUNTY

523a. Lat. 33°39', long. 101°34'.

Date	Water level	Date	Water level	Date	Water level
Feb. 24, 1949	82.78	Jan. 28, 1952	88.50	Jan. 9, 1953	94.36
Jan. 23, 1951	85.37				

528a. Lat. 33°37', long. 101°37'.

Mar. 11, 1947	64.00	Feb. 14, 1950	68.88	Jan. 9, 1953	73.77
Feb. 18, 1948	68.33	Jan. 23, 1951	70.80		
Feb. 23, 1949	69.80	Jan. 22, 1952	74.51		

532. Lat. 33°38', long. 101°36'. Depth 289 feet.

Mar. 12, 1947	67.46	Feb. 14, 1950	67.91	Jan. 23, 1951	72.86
Feb. 24, 1949	69.18				

532a. Lat. 33°38', long. 101°37'.

Mar. 19, 1947	59.24	Feb. 14, 1950	61.40	Jan. 23, 1951	64.79
Feb. 24, 1949	62.83				

533. Lat. 33°39', long. 101°37'. Depth 262 feet.

Mar. 11, 1947	62.50	Feb. 14, 1950	65.98	Jan. 28, 1952	74.12
Feb. 24, 1949	68.08	Jan. 23, 1951	71.00	Jan. 9, 1953	81.34

533a. Lat. 33°39', long. 101°37'.

Mar. 11, 1947	73.28	Feb. 14, 1950	72.69	Jan. 28, 1952	81.55
Feb. 24, 1949	74.53	Jan. 23, 1951	77.80		

560. Lat. 33°40', long. 101°42'.

Mar. 7, 1947	52.75	Feb. 24, 1949	55.90	Jan. 25, 1951	60.70
Feb. 18, 1948	52.77	Feb. 13, 1950	56.88	Jan. 28, 1952	64.32

LUBBOCK COUNTY

571. Lat. 33°37', long. 101°40'. Depth 170 feet.

Date	Water level	Date	Water level	Date	Water level
Nov. 21, 1944	38.70	Feb. 23, 1949	43.62	Feb. 2, 1952	48.77
Mar. 12, 1947	40.16	Feb. 14, 1950	43.26	Jan. 9, 1953	55.12
Feb. 19, 1948	41.13	Jan. 23, 1951	45.90		

574. Lat. 33°37', long. 101°42'. Depth 125 feet.

Mar. 12, 1947	48.09	Feb. 14, 1950	52.86	Jan. 28, 1952	58.28
Feb. 19, 1948	50.19	Jan. 24, 1951	56.90		

579. Lat. 33°37', long. 101°40'. Depth 142 feet.

Mar. 12, 1947	45.66	Feb. 14, 1950	46.46	Jan. 28, 1952	53.06
Feb. 23, 1949	49.42	Jan. 23, 1951	50.65		

580. Lat. 33°36', long. 101°40'. Depth 140 feet.

Mar. 12, 1947	55.27	Feb. 13, 1950	52.69	Jan. 28, 1952	58.07
Feb. 23, 1949	55.00	Jan. 23, 1951	56.10	Jan. 9, 1953	63.57

583a. Lat. 33°36', long. 101°38'.

Mar. 11, 1947	47.86	June 22, 1949	49.50	Jan. 28, 1952	52.15
Feb. 18, 1948	52.12	Feb. 14, 1950	48.01	Jan. 9, 1953	53.30
Feb. 23, 1949	49.87	Jan. 23, 1951	49.72		

595. Lat. 33°36', long. 101°43'.

Mar. 12, 1947	62.10	Feb. 14, 1950	61.47	Jan. 10, 1953	69.93
Feb. 19, 1948	56.21	Jan. 24, 1951	64.75		
Feb. 23, 1949	60.90	Jan. 28, 1952	66.05		

601. Lat. 33°36', long. 101°45'. Depth 132 feet.

Mar. 19, 1947	77.27	Feb. 14, 1950	66.59	Jan. 10, 1953	74.58
Feb. 19, 1948	64.24	Feb. 9, 1951	71.66		
Feb. 22, 1949	67.55	Feb. 1, 1952	70.91		

LUBBOCK COUNTY

609. Lat. 33°38', long. 101°46'.

Date	Water level	Date	Water level	Date	Water level
Mar. 12, 1947	36.51	Feb. 13, 1950	40.91	Jan. 8, 1953	46.82
Feb. 19, 1948	36.70	Jan. 19, 1951	46.60		
Feb. 24, 1949	40.43	Feb. 1, 1952	43.48		

630. Lat. 33°42', long. 101°44'. Depth 243 feet.

Mar. 7, 1947	67.03	Feb. 13, 1950	72.27	Jan. 8, 1953	84.30
Feb. 22, 1949	71.44	Jan. 26, 1952	83.00		

630a. Lat. 33°42', long. 101°44'.

Mar. 7, 1947	68.66	Feb. 13, 1950	71.91	Jan. 8, 1953	83.55
Feb. 19, 1948	68.54	Jan. 24, 1951	74.99		
Feb. 22, 1949	70.92	Jan. 26, 1952	83.69		

644a. Lat. 33°40', long. 101°48'.

Mar. 7, 1947	67.02	Mar. 9, 1949	71.51	Jan. 25, 1951	78.23
Feb. 18, 1948	70.36	Feb. 13, 1950	72.10		

650. Lat. 33°40', long. 101°47'. Depth 180 feet.

Mar. 7, 1947	67.09	Feb. 13, 1950	73.60	Jan. 8, 1953	82.65
Feb. 19, 1948	70.45	Jan. 19, 1951	77.65		
Feb. 24, 1949	73.80	Jan. 26, 1952	80.02		

666. Lat. 33°37', long. 101°50'. Depth 140 feet.

Mar. 29, 1940	52.00	July 28, 1941	53.95	Mar. 3, 1949	59.54
Aug. 13	56.62	Mar. 28, 1942	51.94	Feb. 14, 1950	59.24
Sept. 10	58.18	Dec. 17	50.70	Feb. 9, 1951	61.71
Oct. 13	56.62	Feb. 1, 1943	50.38	Jan. 31, 1952	64.60
Jan. 22, 1941	55.18	Feb. 9, 1944	51.00	Jan. 15, 1953	65.19
Mar. 6	54.87	Jan. 22, 1947	54.96		
June 3	55.20	Mar. 25	54.66		

LUBBOCK COUNTY

677a. Lat. 33°36', long. 101°47'.

Date	Water level	Date	Water level	Date	Water level
Mar. 19, 1947	69.52	Feb. 1, 1952	75.68	Jan. 10, 1953	79.76
Feb. 22, 1949	71.69				

689a. Lat. 33°37', long. 101°52'.

Mar. 8, 1947	46.18	Mar. 7, 1949	52.38	Feb. 15, 1950	51.91
Mar. 3, 1948	48.60				

690. Lat. 33°38', long. 101°52'. Depth 120 feet.

Mar. 8, 1947	44.70	Feb. 15, 1950	49.70	Jan. 12, 1953	59.26
Feb. 20, 1948	46.73	Jan. 19, 1951	52.33		
Feb. 25, 1949	49.36	Jan. 30, 1952	53.90		

702. Lat. 33°41', long. 101°54'. Depth 170 feet.

Mar. 7, 1947	80.23	Feb. 17, 1950	83.24	Jan. 12, 1953	93.29
Mar. 3, 1948	83.27	Feb. 9, 1951	86.10		
Feb. 24, 1949	82.94	Jan. 30, 1952	88.80		

734. Lat. 33°38', long. 101°58'.

Mar. 20, 1947	44.01	Feb. 16, 1950	52.76	Jan. 11, 1953	63.11
Mar. 3, 1948	47.25	Jan. 26, 1951	54.84		
Feb. 28, 1949	51.13	Jan. 30, 1952	58.74		

736. Lat. 33°39', long. 101°59'. Depth 126 feet.

Mar. 8, 1947	40.77	Feb. 16, 1950	46.95	Jan. 30, 1952	52.59
Feb. 28, 1949	45.95	Jan. 25, 1951	49.82	Jan. 11, 1953	56.10

LUBBOCK COUNTY

766. Lat. 33°35', long. 102°01'. Depth 167 feet.

Date	Water level	Date	Water level	Date	Water level
Mar. 8, 1947	84.61	Feb. 28, 1949	90.80	Jan. 25, 1951	93.50
Mar. 1, 1948	88.17	Feb. 16, 1950	90.75	Jan. 11, 1953	104.30

766a. Lat. 33°35', long. 102°00'.

Mar. 8, 1947	86.69	Feb. 28, 1949	88.03	Jan. 25, 1951	91.30
Mar. 1, 1948	88.96	Feb. 16, 1950	88.45	Jan. 11, 1953	101.61

775a. Lat. 33°32', long. 102°02'.

Mar. 10, 1947	77.01	Feb. 16, 1950	82.64	Jan. 11, 1953	93.47
Mar. 1, 1948	79.77	Jan. 30, 1951	87.30		
Mar. 7, 1949	82.27	Jan. 31, 1952	88.15		

776. Lat. 33°32', long. 102°00'. Depth 172 feet.

Mar. 8, 1947	78.08	Mar. 7, 1949	83.53	Jan. 30, 1951	89.43
Mar. 1, 1948	80.49	Feb. 16, 1950	84.58	Jan. 31, 1952	93.70

776a. Lat. 33°32', long. 102°00'.

Mar. 8, 1947	75.31	Mar. 7, 1949	79.20	Jan. 30, 1951	86.25
Mar. 1, 1948	77.33	Feb. 16, 1950	81.17		

776b. Lat. 33°32', long. 102°00'.

Mar. 7, 1949	79.25	Jan. 30, 1951	85.67	Jan. 31, 1952	89.09
Feb. 16, 1950	80.54				

786. Lat. 33°29', long. 102°00'. Depth 165 feet.

Mar. 24, 1947	98.23	Mar. 4, 1949	102.34	Jan. 31, 1952	110.38
Mar. 1, 1948	99.84	Feb. 16, 1950	104.74	Jan. 10, 1953	116.49

LUBBOCK COUNTY

787. Lat. 33°26', long. 102°02'. Depth 193 feet.

Date	Water level	Date	Water level	Date	Water level
Mar. 10, 1947	80.33	Mar. 4, 1949	85.26	Jan. 29, 1952	91.86
Mar. 1, 1948	83.34	Feb. 16, 1950	86.52	Jan. 10, 1953	96.10

787a. Lat. 33°26', long. 102°02'.

Mar. 10, 1947	85.03	Mar. 4, 1949	87.37	Jan. 30, 1951	91.74
Mar. 1, 1948	85.69	Feb. 16, 1950	88.72		

810a. Lat. 33°28', long. 101°57'.

Mar. 8, 1949	104.28	Jan. 30, 1951	100.45	Jan. 10, 1953	106.39
Feb. 16, 1950	98.37	Jan. 31, 1952	101.48		

820a. Lat. 33°24', long. 101°47'. Depth 208 feet.

Mar. 5, 1945	88.60	Mar. 3, 1949	97.17	Jan. 29, 1952	104.19
Mar. 10, 1947	92.50	Feb. 15, 1950	96.40		
Mar. 2, 1948	94.14	Jan. 24, 1951	99.22		

821. Lat. 33°23', long. 101°48'. Depth 161 feet.

Mar. 10, 1947	91.92	Feb. 15, 1950	94.22	Jan. 24, 1951	96.05
Mar. 3, 1949	96.27				

821a. Lat. 33°24', long. 101°49'.

Mar. 10, 1947	90.62	Feb. 15, 1950	93.40	Jan. 29, 1952	99.20
Mar. 3, 1949	97.48	Jan. 24, 1951	96.05	Jan. 10, 1953	104.30

823. Lat. 33°25', long. 101°48'.

Mar. 10, 1947	70.60	Feb. 15, 1950	94.49	Jan. 24, 1951	96.58
Mar. 3, 1949	95.70				

LUBBOCK COUNTY

839. Lat. 33°27', long. 101°52'. Depth 150 feet.

Date	Water level	Date	Water level	Date	Water level
Mar. 27, 1942	78.47	Mar. 2, 1948	85.79	Feb. 1, 1952	93.38
Feb. 16, 1943	77.68	Mar. 3, 1949	88.68	Jan. 10, 1953	94.65
Mar. 5, 1945	78.22	Feb. 16, 1950	88.84		
Mar. 19, 1947	82.92	Jan. 24, 1951	90.59		

843a. Lat. 33°29', long. 101°50'. Depth 155 feet.

Mar. 2, 1947	74.37	Feb. 16, 1950	76.71	Jan. 10, 1953	90.99
Mar. 2, 1948	75.83	Jan. 24, 1951	79.90		
Mar. 3, 1949	77.24	Feb. 1, 1952	84.73		

847. Lat. 33°31', long. 101°50'. Depth 120 feet.

Mar. 8, 1939	82.27	Feb. 21, 1945	76.69	Mar. 3, 1949	84.22
June 30	82.41	Mar. 21, 1947	78.16		
Feb. 5, 1944	77.06	Mar. 10, 1948	81.75		

853a. Lat. 33°32', long. 101°47'. Depth 112 feet.

Mar. 11, 1947	47.13	Feb. 15, 1950	48.97	Jan. 10, 1953	51.47
Mar. 10, 1948	47.54	Jan. 24, 1951	49.47		
Mar. 3, 1949	49.28	Feb. 1, 1952	51.79		

868a. Lat. 33°27', long. 101°47'.

Mar. 10, 1947	72.75	Mar. 3, 1949	75.44	Jan. 27, 1952	83.30
Mar. 2, 1948	71.74	Feb. 15, 1950	75.27		

868b. Lat. 33°27', long. 101°47'. Depth 163 feet.

Mar. 10, 1947	81.06	Mar. 3, 1949	88.94	Jan. 29, 1952	96.63
Mar. 2, 1948	83.10	Feb. 14, 1950	88.28	Jan. 10, 1953	102.90

LUBBOCK COUNTY

878b. Lat. 33°33', long. 101°38'. Depth 147 feet.

Date	Water level	Date	Water level	Date	Water level
Mar. 11, 1947	50.73	Feb. 14, 1950	53.46	Jan. 28, 1952	56.64
Feb. 23, 1949	53.80	Jan. 23, 1951	55.27	Jan. 9, 1953	60.90

887b. Lat. 33°33', long. 101°38'.

Mar. 11, 1947	70.15	Feb. 14, 1950	71.74	Jan. 9, 1953	76.04
Mar. 10, 1948	70.84	Jan. 23, 1951	71.83		
Feb. 23, 1949	72.03	Jan. 28, 1952	73.34		